

Series 2400

• Manual (MX) or Power Rewind • Oxy/Fuel Welding

To handle twin 1/4" through 3/8" welding hose.

- MX chain-driven crank rewind or powered by a compressed air or hydraulic motor.
- MX rewind reels supplied with a pinion brake.
- Power reels not supplied with a brake.
- Standard inlets: 90° ball bearing swivel joints with 1/2" female NPT threads. Oxy/acet brass inlet adapters are available.
- Standard outlets are male 9/16"-18 threads. Right-hand for oxygen, left-hand for gas.
- Pressures to 300 psi (21 bar).
- Temperatures from -40°F to +200°F (-40°C to +93°C).
- Type of gas used must be specified.

Model A2400

- Rollers and roller mounting brackets are accessory items. Specify roller position.



Series MX2400

Standard configuration shown with MX rewind

Series A2400

Standard configuration shown with air rewind

PARTS DRAWING – ISO 187 POWER; ISO 213 MANUAL (MX)

Model Number For power rewind see Note 5	Hose Capacity of Reel feet m			Approx. Weight lb. kg		Reel Dimensions*** in. mm						
	I.D. in. mm	1/4 6	3/8 9	NET	SHIP	A	B	E MX	E POWER	F MX	F POWER	X
	O.D. in. mm	.53 13	.66 17									
MX2414-17-18		2/100	2/75	31	54*	11	6	18.5	19	28.5	18.75	9.5
		2/30	2/23	14	24	279	152	470	483	724	476	241
MX2416-17-18		2/150	2/100	32	54*	13	8	18.5	19	30.5	20.75	11.5
		2/46	2/30	15	24	330	203	470	483	775	527	292
MX2420-17-18		–	2/150	34	68*	17	12	18.5	19	34.5	24.75	15.5
		–	2/46	15	31	432	305	470	483	876	629	394
MX2426-17-18		–	2/200	36	84*	23	18	18.5	19	40.5	30.75	21.5
		–	2/61	16	38	584	457	470	483	1029	781	546

Notes:

- Specifications subject to change.
 - Upon request, reels can be supplied with drum lengths other than shown and with disc sizes in other diameters.
 - Weights shown in chart are for crank rewind models. ADD these amounts for power rewind models:
- | | | |
|------------------|---------------|---------------|
| | Net lbs/kg | Ship lbs/kg |
| Hydraulic | 15/6.8 | 15/6.8 |
| Air | 15/6.8 | 15/6.8 |
- Dimension "F" is the overall length of standard model reels. On crank rewind models, the dimension shown is with the crank in rewind position. Reels require 2" clearance to remove crank handle.
 - When ordering power rewind models replace MX prefix with:
 - A** = Air Rewind
 - HD** = Hydraulic Rewind
 (Air rewind reels are supplied with control valve and 18" air hose; hydraulic rewind reels are not supplied with control valve.)

6. Be sure to check dimensions and weights prior to ordering.

- For welding hose and cable specifications see page 10.
- Some roller options may prohibit the use of our molded chain guard.
- See page 9 for optional External Mounting Brackets.
- Finish:** Refer to Ordering & Accessory catalog page 19.

NOTICE: A Flexible Connector must be used between the inlet pipe and the inlet swivel joint.

* Dimensional weight may apply when shipped as a parcel package (via FedEx or UPS Ground).

*** X, Y indicate mounting holes. See page 10.

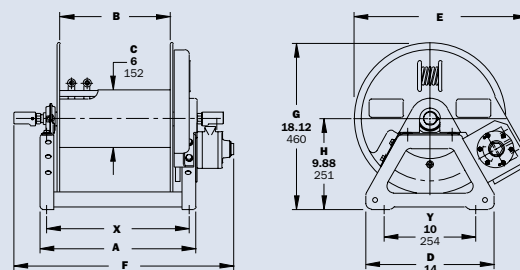

Power Rewind

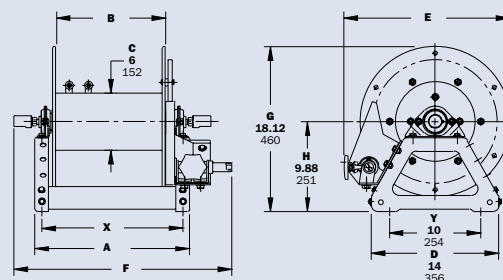

Manual MX

