

# Series AVC1150/AVATC1250

## Reels on wheels and compact storage.

These direct crank rewind reels are equipped with one-piece foot, and removable steel handlebar for long-term storage and shipping.

- Cam-lock brake is standard.
- Non-reflective black matte finish is standard.
- Equipped with one durable rubber twist tie for cable ends. Divider disc models equipped with additional tie.
- For compact storage, optional folding handle or removable crank handle are available.
- Optional divider discs are available.

### AVC1150

- Hard rubber tires and a 7/8" x 1-3/4" (22.2 mm x 44.4 mm) opening in the drum.
- Optional pneumatic tires available. See Note 3.

### AVATC1250

- Pneumatic tires and a 4" x 5-1/2" (101.6 mm x 139.7 mm) drum opening.
- Large capacity spool.



**AVC1150**  
Shown with optional  
folding handle

**AVATC1250**  
Standard configuration shown



**AVC 1150/1250 Series includes one durable rubber twist tie for cable ends. Divider disc models with two.**  
Part No. 9949.0082

## PARTS DRAWING – AVC 1150–ISO 48, AVATC 1250–ISO 87

Model Number	Cable Capacity of Reel feet m								Approx. Weight without cable lb. kg			Reel Dimensions in. mm							
	O.D. (in) O.D. (mm)	.25 6	.38 10	.41 10	.45 11	.49 12	.58 15	.67 17	NET	UPS/ FedEx. SHIP Wt.	Freight SHIP Wt.	A	B	C	D	E	F	G	H
AVC1150	—	950	800	700	575	425	250	44	100*	79	21.5	12	6	21	16.5	25	39	13.81	
	—	290	244	213	175	130	76	20	45	36	546	305	152	533	419	635	991	351	
AVATC1250	—	1800	1500	1200	1000	800	500	82	147*	117	24.88	11.5	8	23.31	23	27.25	40	17.25	
	—	549	457	366	305	244	152	37	67	53	632	292	203	592	584	692	1016	438	

### Notes:

1. Specifications subject to change.
2. Be sure to specify model number, O.D., length and weight of cable, etc.
3. Optional AT wheels on AVC1150 increase dimensions. Add 3-1/4" to dimension "A," add 5" to dimension "F."
4. Be sure to check dimensions and weights prior to ordering.

\* Dimensional weight applies when shipped as a parcel package (via FedEx or UPS Ground). Some assembly required.

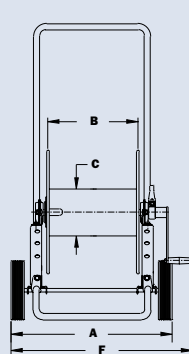

AVC1150

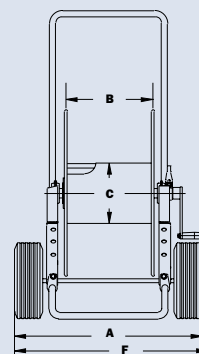
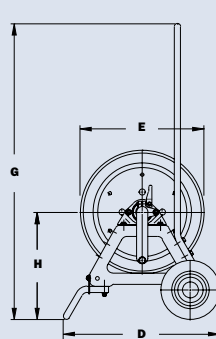

AVATC1250

