

Model AT1300/4300

• Industrial Maintenance • Broadcast • Construction • Agriculture • Grounds Maintenance

Model AT1300

- Removable direct crank rewind reel.
- Adjustable cam-lock drag brake.
- 3-conductor, 45-amp collector ring is standard.
- 6 foot power source lead of 10/3 cable.
- 15-amp, 3-prong straight blade (optional twist lock is available).
- Additional conductors available; consult factory.
- Direct offset rewind crank.

Aluminum Hand Truck

Model 4300-AL

Part No. 9906.0795

For portability of hose and cable reels.

- Large pneumatic tires.
- Reel permanently attached.
- Overall dimensions will vary according to the reel model used.
- Hand truck, axle, and wheels shipped separately for customer installation. Specify if reel axis is perpendicular or parallel to truck axle.

Model AT1300



Assembled 4300-AL truck with reel attached



PARTS DRAWING – ISO 189

Model Number	Cable Capacity of Reel feet m				Approx. Weight lb. kg		Reel Dimensions in. mm							
		Ga./No. of Conductors												
		14/3	12/3	10/3			A	B	C	D	E	F	G	H
	O.D. in. mm	.53 14	.60 15	.69 18	NET	SHIP								
AT1300		500 152	400 122	300 91	70 32	102 46	25.88 657	12 305	6 152	22.62 575	16.5 419	32.5 825	42.5 1080	14.38 365

Notes:

1. Specifications subject to change.
2. Hand truck is also sold separately.
Maximum reel size dimensions when installed on hand truck:
A=32" (812.8 mm), B=27" (685.8 mm), E=32" (812.8 mm).
3. Be sure to check dimensions and weights prior to ordering.

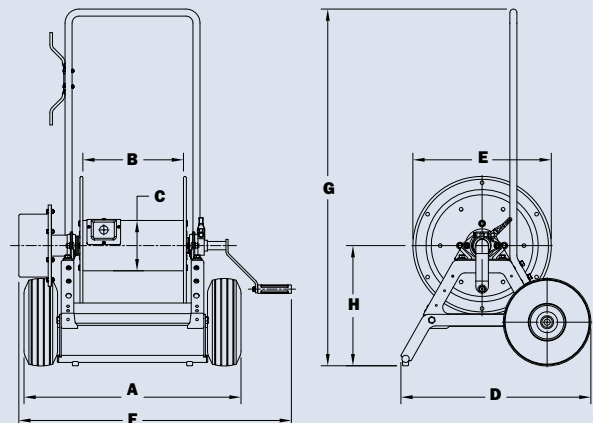

Model AT1300